



TRAFFIC ADVISORY

SAM RAYBURN TOLLWAY (SRT)

Full northeast-bound SRT closures at I-35E scheduled continuously March 3-6 and nightly through March 12

The following closure is scheduled for the Texas Department of Transportation's [35Express project](#):

8 p.m. Friday, March 3, through 5 a.m. Monday, March 6 (Continuous), and nightly from 8 p.m. to 5 a.m. Monday, March 6, through the morning of Sunday, March 12

- Northeast-bound entrance ramp from MacArthur Boulevard closed.

10 p.m. Friday, March 3, through 5 a.m. Monday, March 6 (Continuous), and nightly from 10 p.m. to 5 a.m. Monday, March 6, through the morning of Sunday, March 12

- All lanes of the northeast-bound SRT between the MacArthur Boulevard exit and Interstate 35E closed.
- Northeast-bound SRT to southbound I-35E direct-connector ramp closed.

Detour: Northeast-bound SRT motorists will exit at MacArthur Boulevard and continue east on State Highway 121 (SRT frontage road) to the entrance ramp from I-35E.

TxDOT's 35Express project is a \$1.4-billion expansion of I-35E between U.S. 380 in Denton County and I-635 in Dallas County. For more information on the project and to sign up to receive text alerts, please visit www.35Express.org or call 214-483-7777.

Message boards will be placed nearby to advise motorists of the closures. All closures are subject to weather conditions and may be postponed, if necessary.

For more information about upcoming lane closures and traffic-related news along NTTA roadways, go to the "Scheduled Lane Closures" link at www.ntta.org.

About the NTTA

[The North Texas Tollway Authority](#), a political subdivision of the state of Texas, is authorized to acquire, construct, maintain, repair and operate turnpike projects across the north Texas region. The [nine-member board](#) is comprised of Chairman Kenneth Barr; Vice Chairman Bill Moore; and Directors William D. Elliott, Mojoy Haddad, John Mahalik, Michael Nowels, George "Tex" Quesada, Carl O. Sherman and Jane Willard.

NTTA serves Collin, Dallas, Denton, Tarrant and Johnson counties and owns and operates the Dallas North Tollway, President George Bush Turnpike, Sam Rayburn Tollway, Addison Airport Toll Tunnel, Lewisville Lake Toll Bridge, Mountain Creek Lake Bridge and Chisholm Trail Parkway. NTTA raises capital for construction projects through the issuance of turnpike revenue bonds. NTTA toll projects are not a part of the state highway system and receive no direct tax funding. Tolls are collected to repay debt and to operate and maintain the roadways.

###

Closure of Northeast-bound Sam Rayburn Tollway Between MacArthur Boulevard and the Northbound Interstate 35E Frontage Road

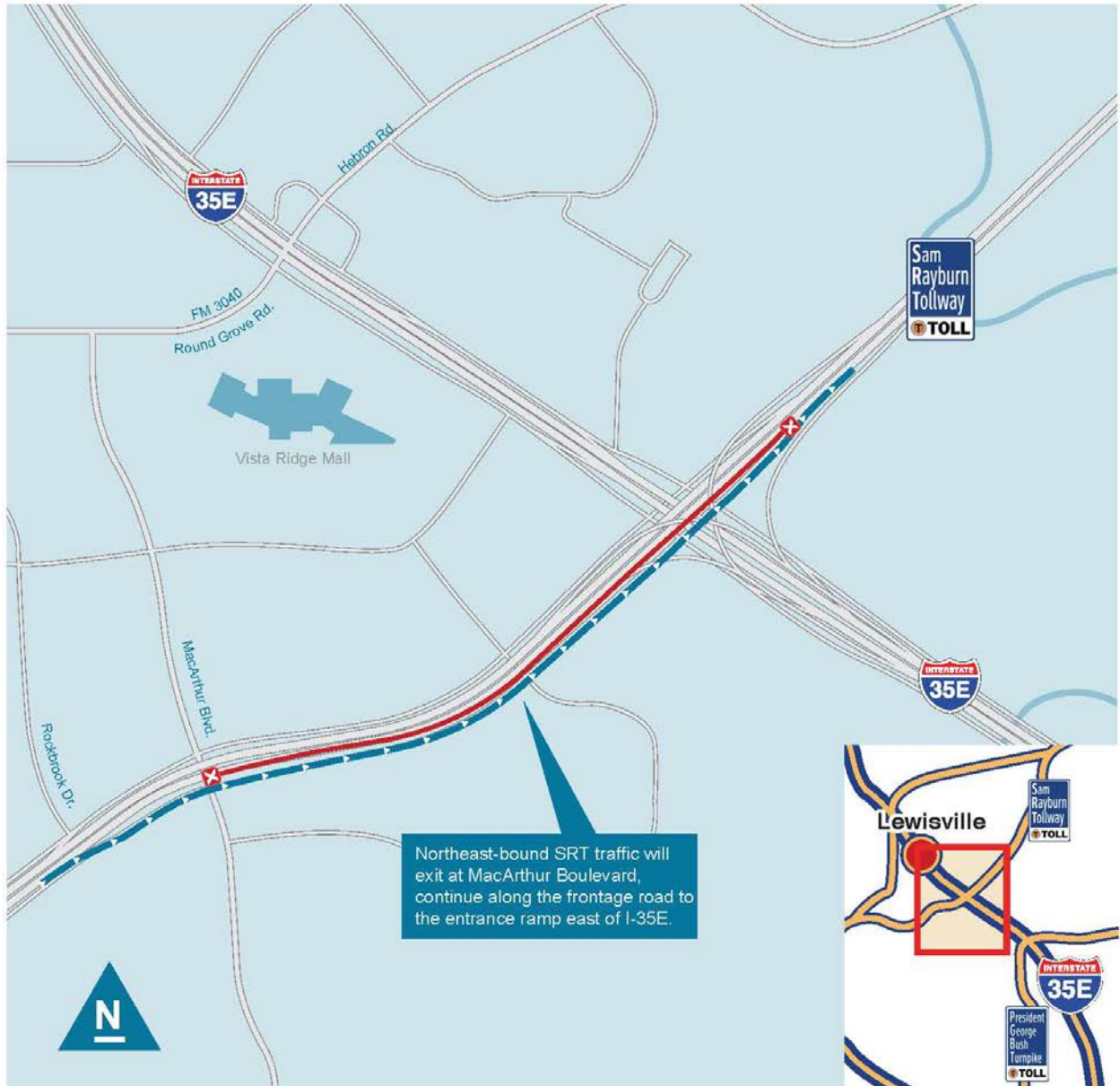

f I35Express
t 35Express

214-483-7777
info@35Express.org

To find out more log onto www.35Express.org

